

BP12BS2 Back pressure valve in brass



DESCRIPTION

Back pressure valves are the most appropriate solution to avoid possible failures and risks resulting from excess pressure in an installation.

They discharge excess gas to the outside when the pressure at the control point exceeds the set pressure. Pressure is controlled by a diaphragm or a piston that, together with a balanced shutter, ensure precision and repeatability of regulation.

Body and inner parts are made of brass with excellent mechanical resistance.

Panel mounting with bracket available.

Degreased for oxygen use and pure gases versions available.

Applications: automotive, pneumatics and industry.

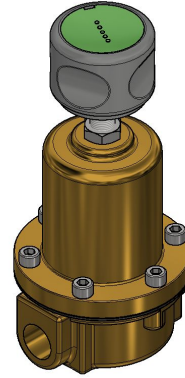

TECHNICAL DATA

| | |
|------------------------|---|
| MAXIMUM INLET PRESSURE | 60 bar |
| IN/OUT CONNECTIONS | 1/4" • 1/2" (G-F / NPT-F) |
| SETTING RANGE | 0 → 3 bar • 0 → 8 bar • 0 → 15 bar 0 → 30 bar • 0 → 50 bar |
| MATERIAL | Body - brass Inner parts - brass |
| TEMPERATURE | -20°C → +80°C Other temperatures upon request |
| FLUIDS | Gases • Liquids |
| WEIGHT | 2,8 kg |
| CERTIFICATES | PED 2014/68/UE |
| ACCESSORIES | Bracket |
| SPARE PARTS KIT | Wear parts |

DIMENSIONAL DRAWINGS

DIAPHRAGM

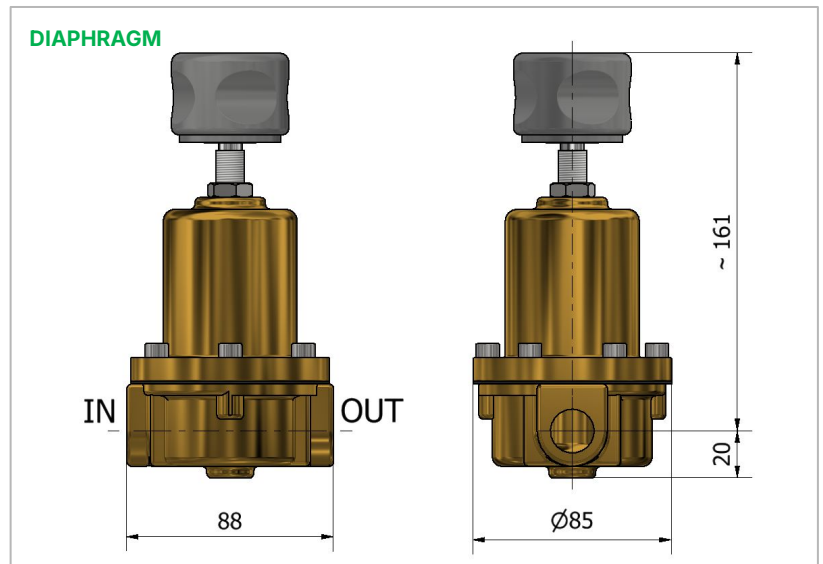

PISTON

